



### THE SPINE

The SPINE is the LIFELINE's cultural backbone. A gently sloping path brings pedestrians up through a shaded colorful space containing galleries, boutiques and restaurants of Miami's favorite local vendors. A local food hall and market opens on the pedestrian corridor allowing for easy access to some of the best food and groceries around. The food hall is serviced by the new MICRO DISTRIBUTION CENTER which allows for local freight to unload at the LIFELINE and sell their wares along the spine and distribute them to the community.



### THE WOONERF

THE WOONERF is a new residential street that continues the trajectory of the existing street region just north of the LIFELINE. This shared space serves as an entry point for the LIFELINE's residents. It additionally helps calm traffic from the north as it makes its way into THE OASIS. Entry points to parking garages and live work units invites cars into the space, yet walking is prioritized with plantings and bollards designed to foster a safe and pleasing environment.

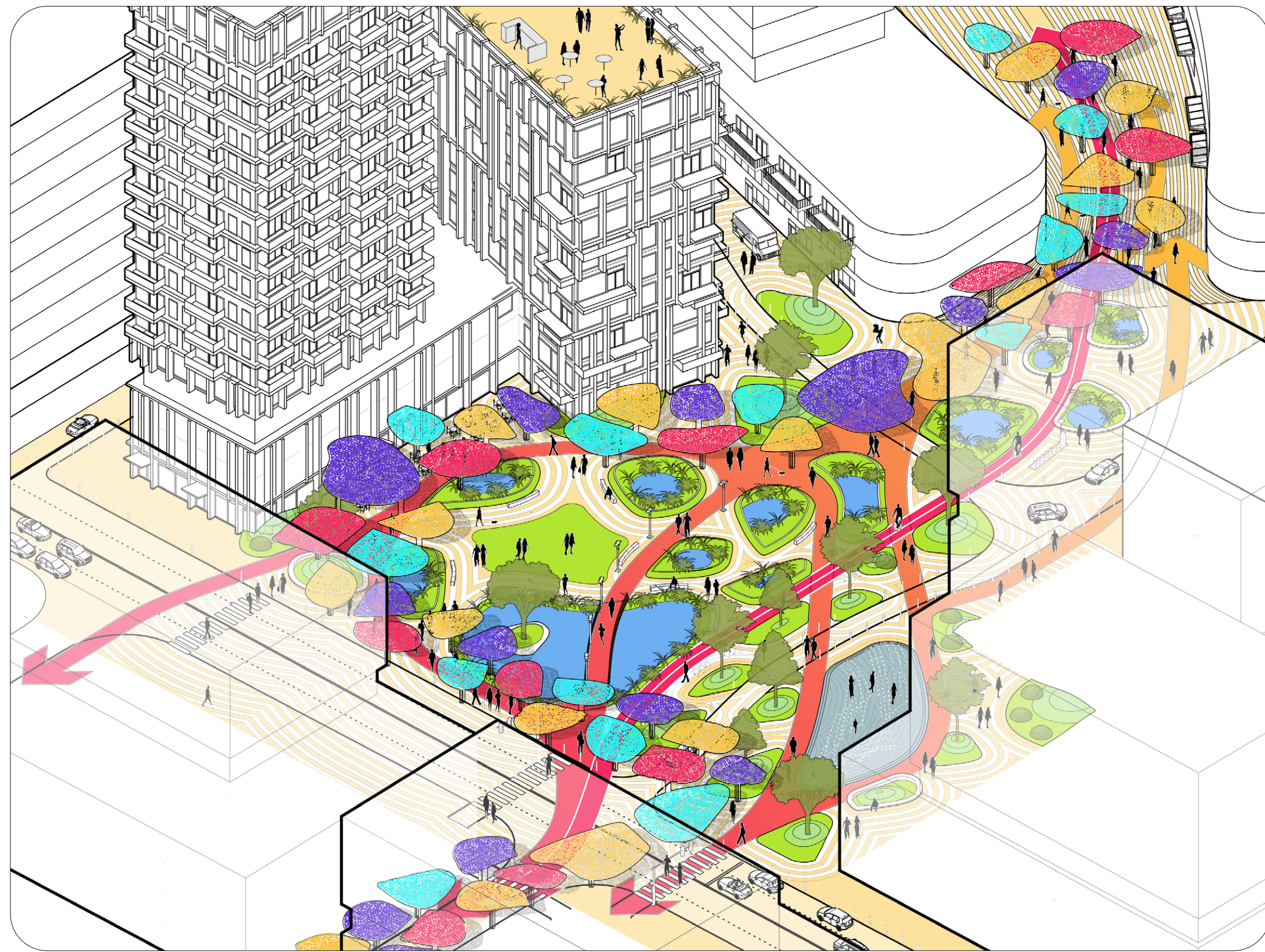

### THE OASIS

THE OASIS serves the primary gateway from Wynwood to the LIFELINE. A lush urban plaza greets pedestrians via a curbside shared pedestrian space. Vegetated bioswales gently guide visitors up through the SPINE or into the Woonerf through a dual purpose water retention basin and urban habitat via a promenade of native species and dappled sunlight. The colorful canopy enlivens the space and provides a shaded scenic route throughout the LIFELINE's cultural corridor.

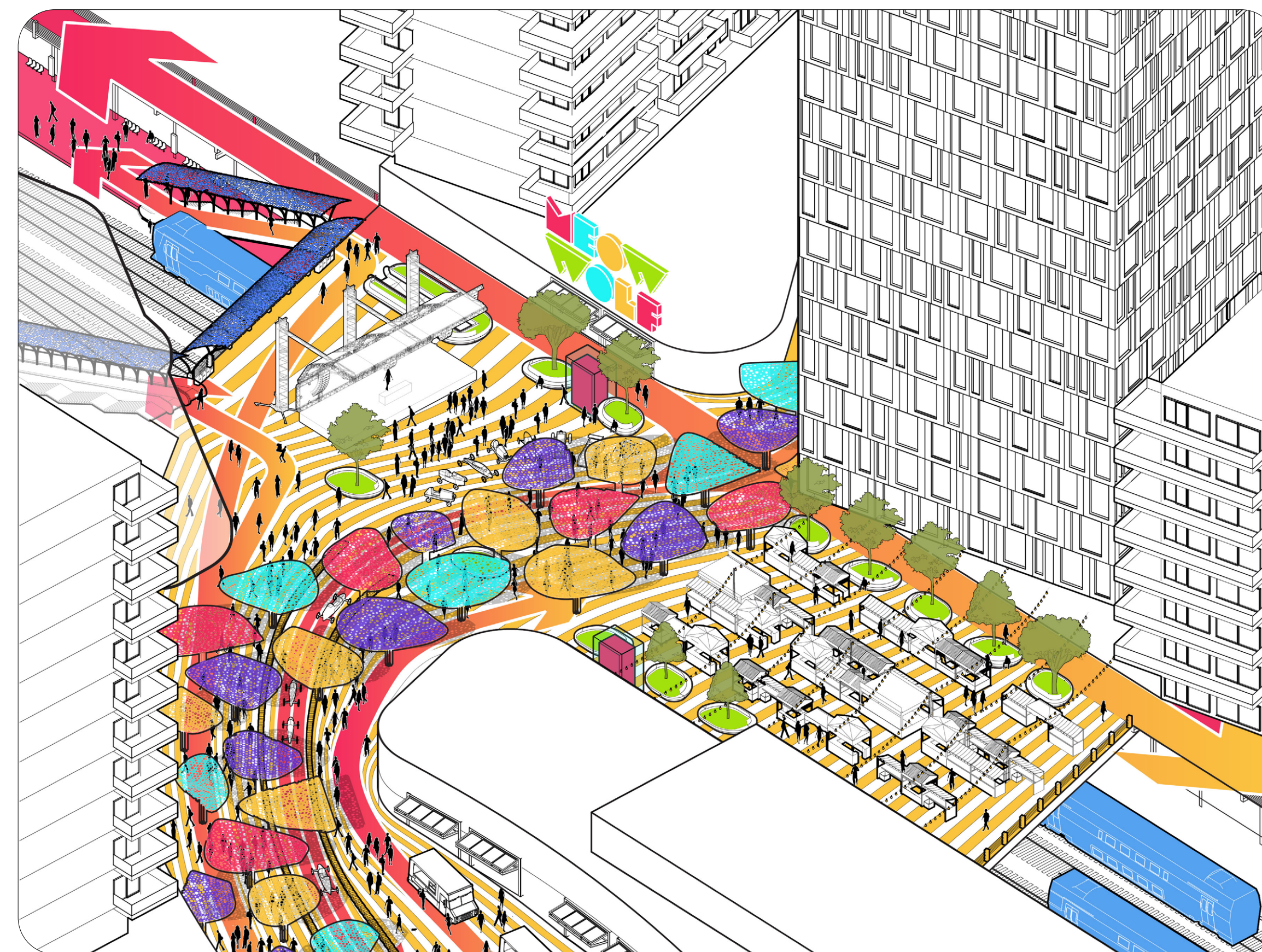

### THE STAGE

THE STAGE is where life happens and people gather on the LIFELINE. The deck allows for a generous event space that can host farmers markets, concerts, soap box derbys, and more all while insulating the pedestrian corridor from train noise. The deck also serves to shelter the brand new Tri-Rail stop from the elements and provide an easy entry point to the new station. Additionally it serves as another adaptable public space and museum plaza for the Nader Art Museum of Latin America.

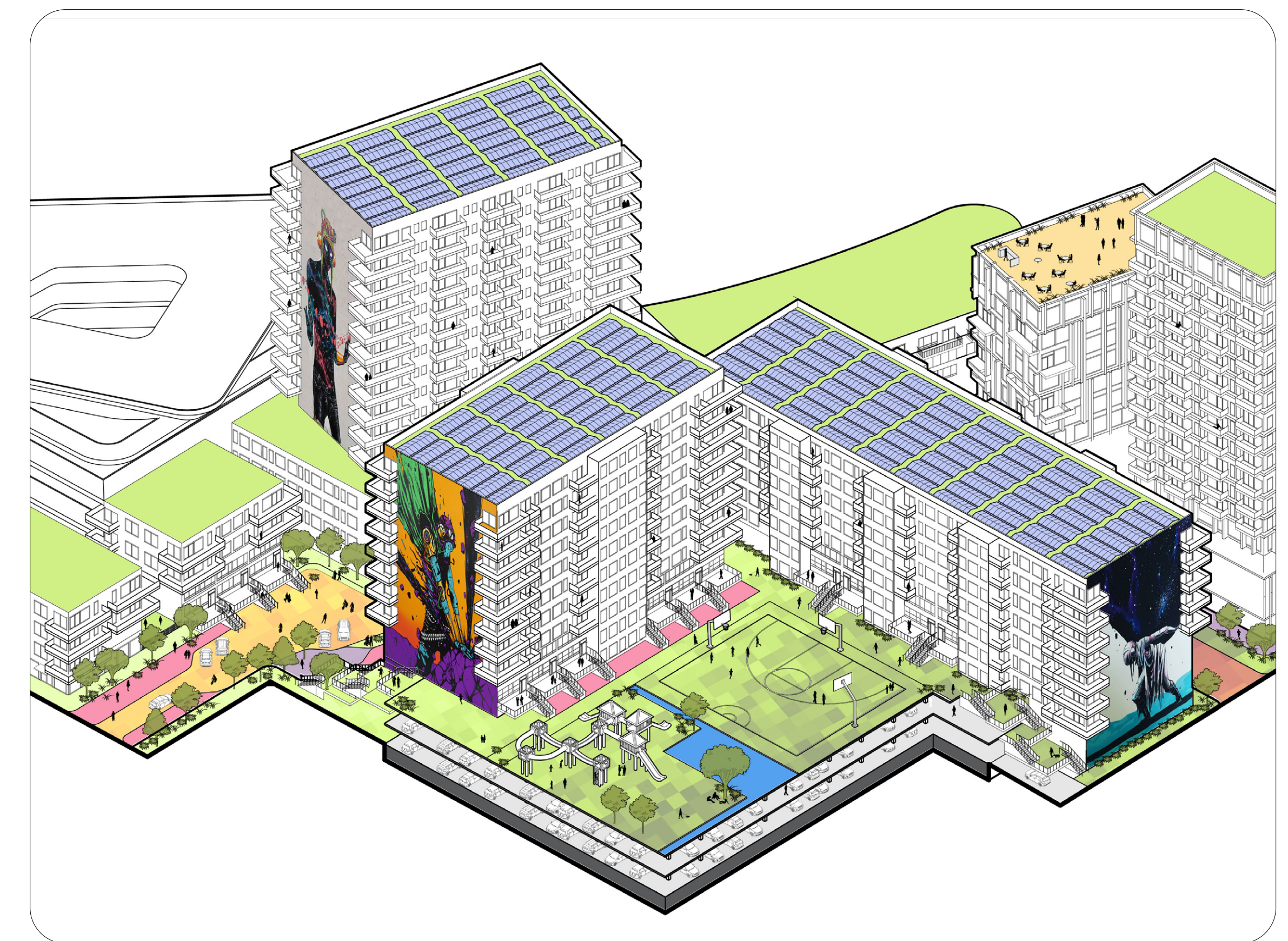

### RESIDENTIAL BLOCK

Housing is a primary focus of the LIFELINE in addition to its bustling cultural corridor. Multi family housing complexes are arranged around a central courtyard that contains amenities for the residence. The housing sits atop a parking structure ringed with retail and live work units. This provides all the parking necessary for the residents and the adjacent public features. Additionally, the parking structure provides a flood-able level to mitigate the high tides.

